



Heavy duty
30 000 BTU
Burners

Cast Iron grates
305mm x 305mm

Open
Bottom tray

Storage
Bottom
Shelf



FGS0004

STOVE HOB 4 PLATE

SPECIFICATIONS

OUTPUT	120 000 BTU
PACKAGING (W x D x H)	820 x 950 x 1000 (mm)
UNIT (W x D x H)	800 x 815 x 945 (mm)
NET WEIGHT	113kg
GROSS WEIGHT	118kg
SHIPPING VOLUME	0.74m ³
SURFACE	Flat
GRATE SIZE	305 x 305 (mm)

MODEL

FGS0004



AVAILABLE IN: LPG & Ngas



FEATURES

MODEL: FIS0001

- Heavy duty induction stove built for high demand commercial kitchens.
- Dual glass surface with two 5kW induction coils per plate, spaced to accommodate larger pots.
- Stainless steel construction with front mounted controls for safe operation.
- Heats only the pan and its contents, keeping the tempered glass surface cool and safe.
- Rapid on demand heating with precise control, using up to 30% less electricity than traditional electric cooking.

NOTE:

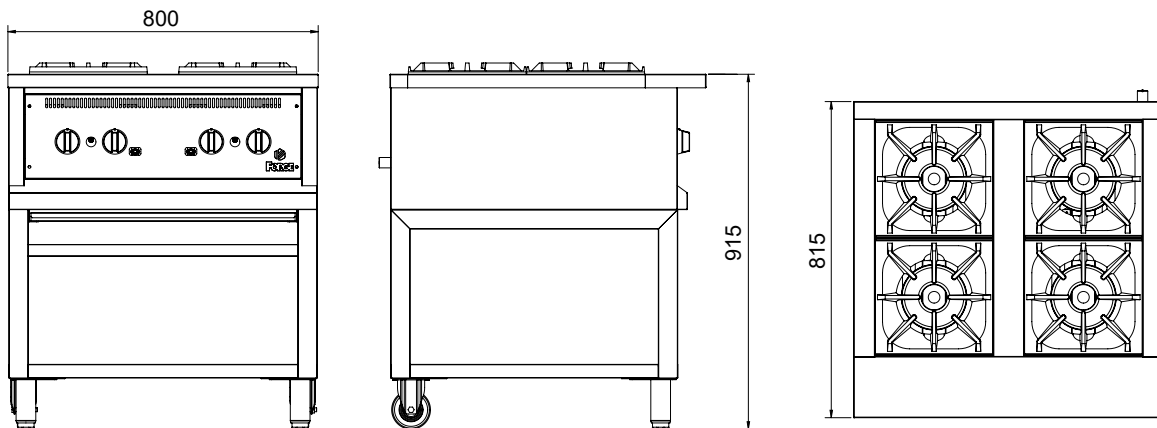

NOTE

When viewing the appliance from the front in its usual operating position, the width (W) of the product is the total distance from left to right; the depth (D) of the product is the total distance from the front to the back; the height (H) is the total distance from the bottom of the product to the top. Pictures may vary from actual product.

DISCLAIMER

Output performance figures quoted are dependant on various factors. Anvil reserves the right, without notice, to make changes and revisions to product specifications, materials and design, when we believe it will provide better performance, durability, and efficiency. Unit measurements may vary depending on point of reference.

